

Property Line

Property Line

Note:
Indicate location of all buildings
on the Property, including sizes

SAMPLE ONLY

Note:
Do not submit this Sample Site Plan
as part of your Drawing Package.

Plans submitted for review are to be drawn
to a recognized scale. (ie 1"=20'-0")

Setback requirements:

- 1) Interior Side yard with the side facing the
same lot line 'Being Closed', no closer than
4'-0" from the lot line
- 2) Measurement for Setback taken from
Outside Overhang or Eavestrough if
installed.
(Whichever is closest)

Existing Dwelling

Proposed Carport

15'-0"

Site Specific

Indicate post spacing

Broken Line denotes
Outline of Roof Overhang

20'-0"

Site Specific

9.35.2.1

Where a Roofed Enclosure used
for the storage or parking of
Motor Vehicles has more than
60% of total perimeter Enclosed
by Walls, Doors or Windows, the
Enclosure shall be considered a
Garage.

Property Line

STREET

Property Line

Site Specific
(must meet Front Yard
Setback Requirements)

NOTE:

It is the Contractor's responsibility to ensure that
all construction conforms to the requirements of
the Ontario Building Code. Notations made on
these drawings are for your information and
assistance only and do not necessarily comment
on all areas of construction.



ONTARIO, CA
COCHRANE
WONDERFULLY UNEXPECTED

Attached Carport SITE PLAN

SCALE: NTS

DRAWN BY: E.P.

DATE: 2012

CP-1
SHEET

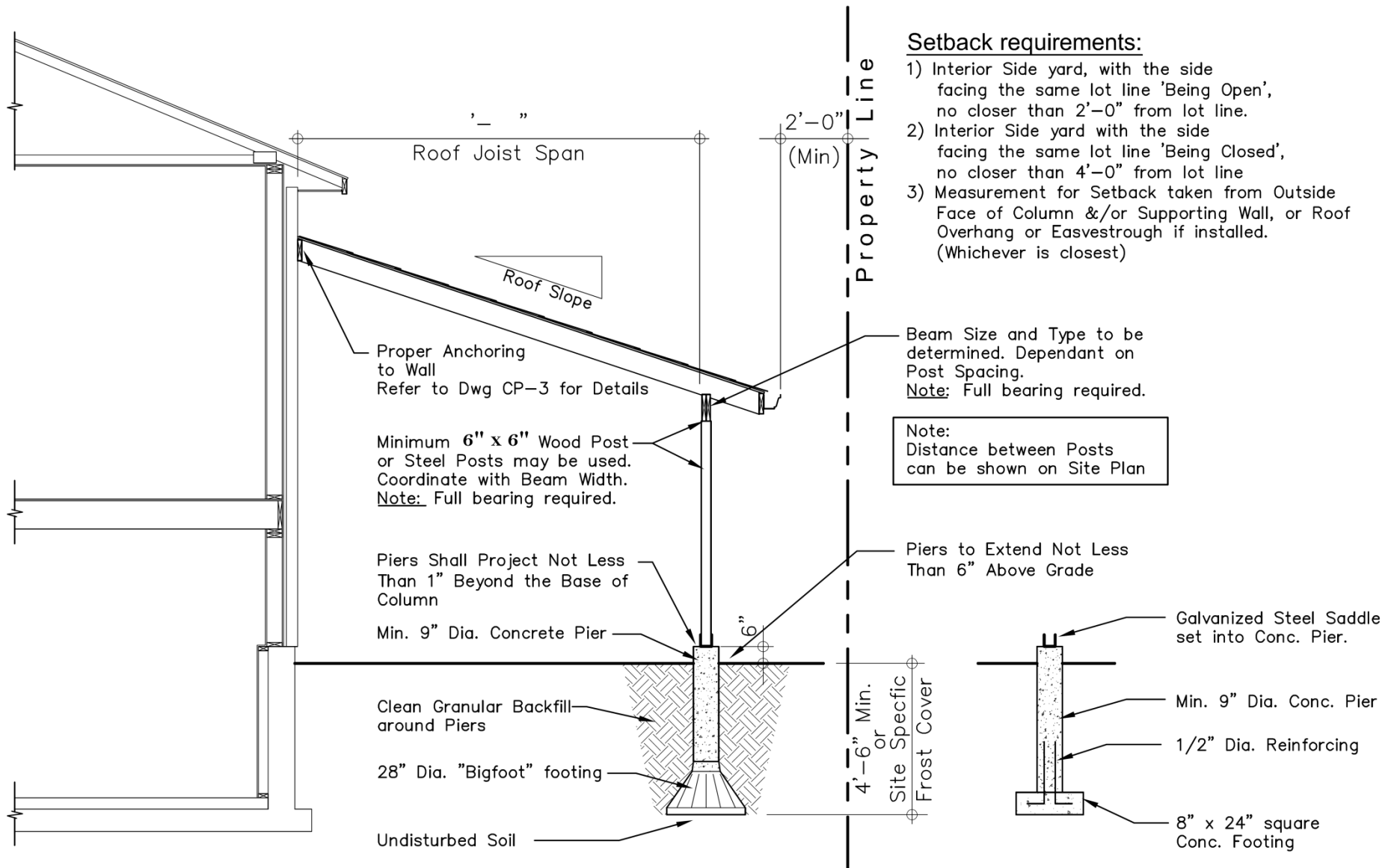

NOTE:

It is the Contractor's responsibility to ensure that all construction conforms to the requirements of the Ontario Building Code. Notations made on these drawings are for your information and assistance only and do not necessarily comment on all areas of construction.



Attached Carport

CROSS SECTION

SCALE: NTS

DRAWN BY: E.P.

DATE: 2012

CP-2
SHEET

NOTE:

THESE DETAILS APPLY
TO CARPORTS ONLY

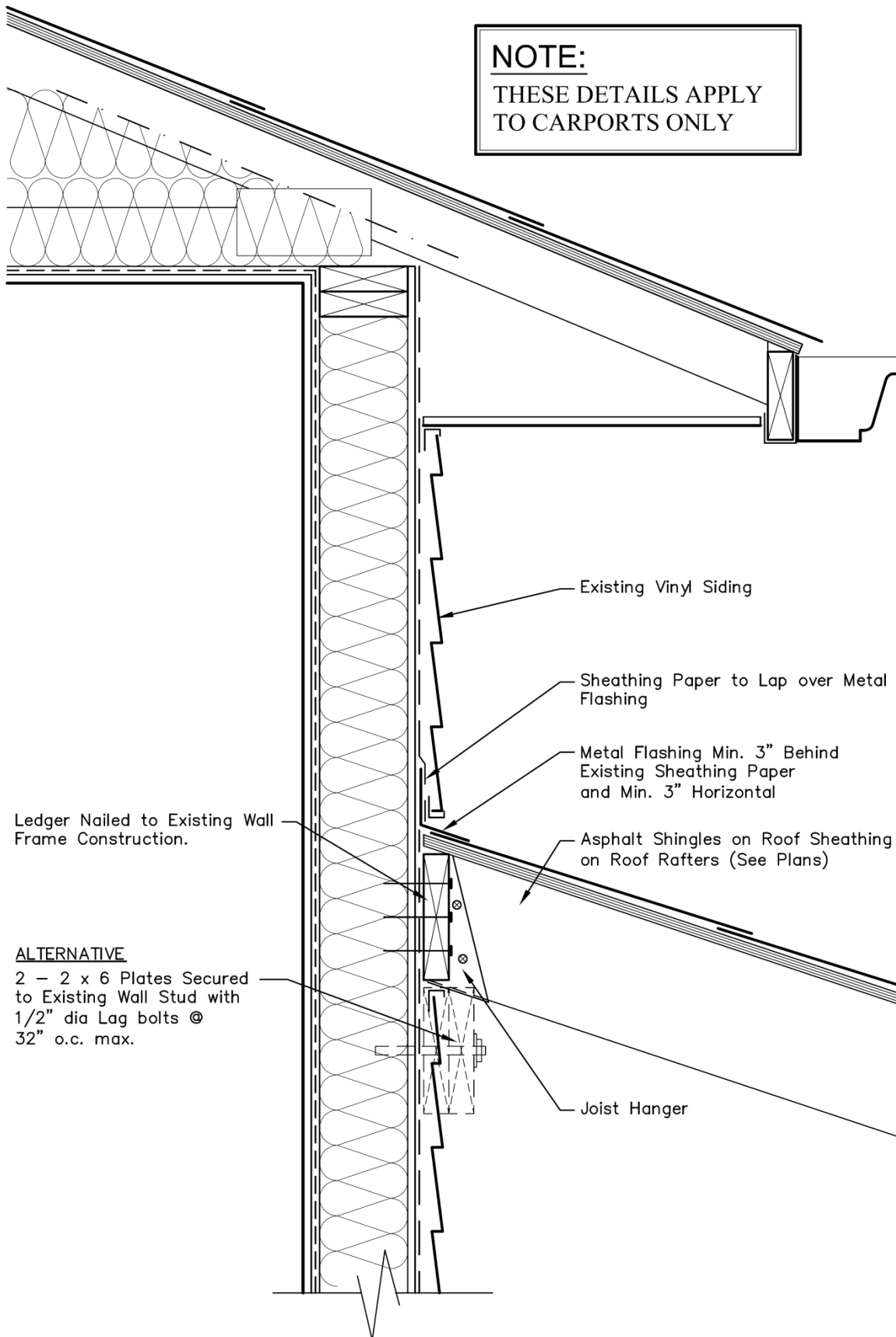

Connection Detail @ Vinyl Siding Wall

DRAWN BY: E.P.

DATE: 2012

CP-3
SHEET

SCALE: NTS

Attached Carport

DETAILS



NOTE:

It is the Contractor's responsibility to ensure that all construction conforms to the requirements of the Ontario Building Code. Notations made on these drawings are for your information and assistance only and do not necessarily comment on all areas of construction.

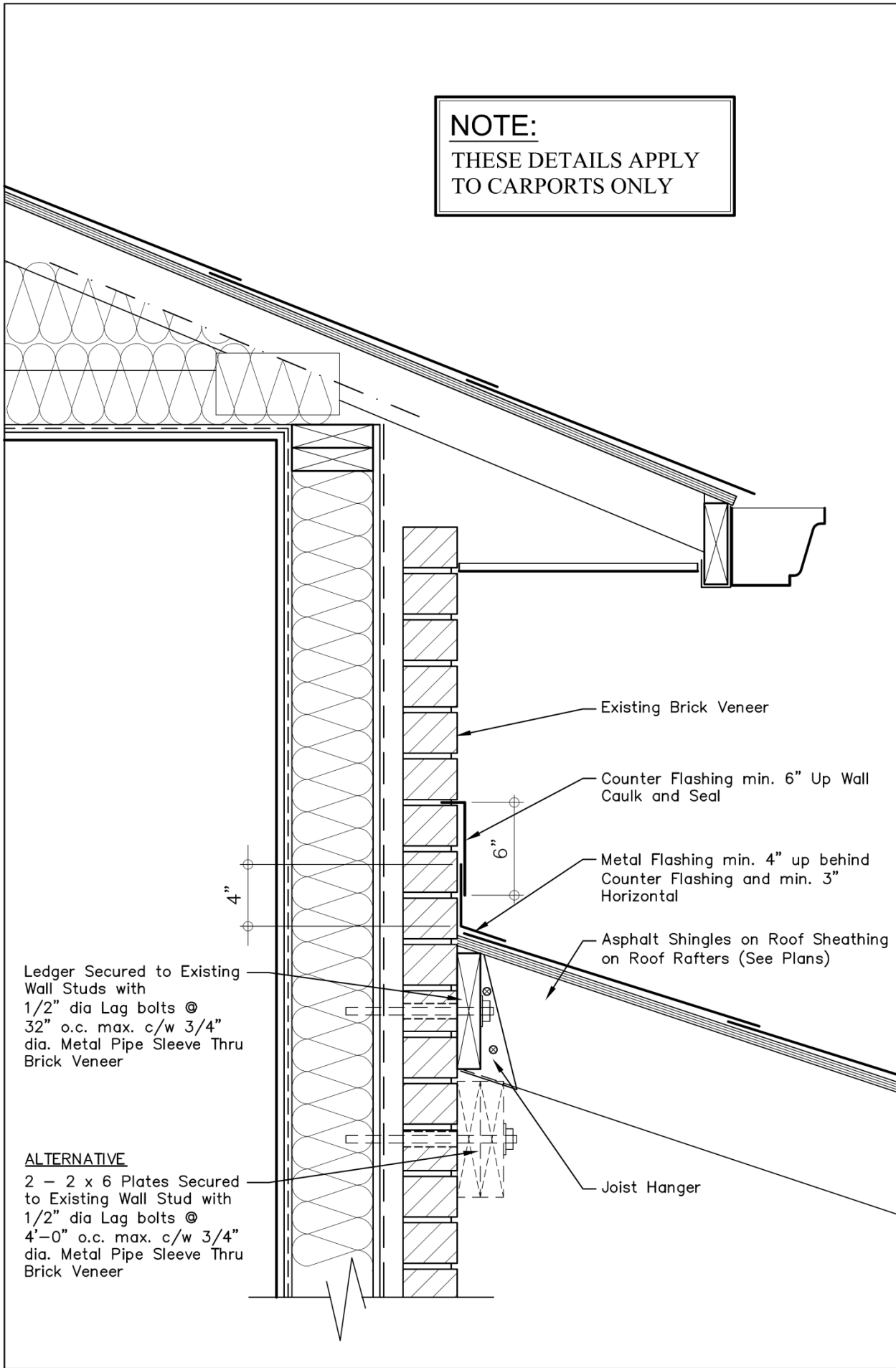

NOTE: It is the Contractor's responsibility to ensure that all construction conforms to the requirements of the Ontario Building Code. Notations made on these drawings are for your information and assistance only and do not necessarily comment on all areas of construction.	DRAWN BY: E.P. DATE: 2012	CP-4 SHEET
	Attached Carport DETAILS SCALE: NTS	
ONTARIO, CA COCHRANE WONDERFULLY UNEXPECTED		